

MICRO3™ Blade Fuses

Rated 32V

RoHS

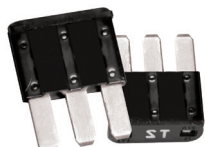

MICRO3™ Shunt

Specifications

Voltage Rating:	32 V dc
Interrupting Rating:	1000A @ 32 V dc
*Recommended Environmental Temperature:	-40 °C to +125 °C
Terminals Material:	Silver plated zinc alloy
Housing Material:	PA66 (U.L. 94 Flammability rating – V2)
Net Weight per Fuse:	0.95 g ± 10%
Complies with:	SAE 2741 and ISO 8820-3 in reference to electrical, mechanical and environmental performance requirements

*Silver plating allows up to 150°C at the terminal interface.

Description

MICRO3™ automotive blade fuses feature three silver-plated blades and two fuse elements while also boasting subminiature design. This allows automakers to pack more circuit protection into less space. Despite their low weight, MICRO3™ fuses perform well in adverse environments and at extreme temperatures.

Features & Benefits

- Color coding shows the amperage rating for each fuse
- See-through housing makes it easy to check whether a fuse has blown
- Checkpoints on top make it possible to measure resistance without removing the fuse
- High-contrast amperage stamp on the top of the housing aids identification
- Simple to install and remove

Applications

- Cars
- Trucks
- SUVs
- Offroad vehicles
- Buses
- Watercraft as approved by Littelfuse®







Ordering Information

Part Number	Rating	Package Size
0337xxx.PX2S	3-15 & SHUNT	2000
0337xxx.LXS	3-15	50

MICRO3™ Blade Fuses

Rated 32V

Ratings

Part Number	Current Rating (A)	Housing Material Color	Test Cable Size (mm ²)		Typ. Voltage Drop (mV)	Typ. Cold Resistance (mΩ)	Typ. I ² t (A ² s)
			Side Fuse Blades	Center Fuse Blades			
0337003_	3		0.5	1	113	31.7	9
0337005_	5		0.5	1	116	17.4	17
033707.5_	7.5		0.75	1.5	106	10.8	47
0337010_	10		1	2.5	102	7.8	89
0337015_	15		1.5	4	94	4.9	189
0337900_	SHUNT		-	-	-	-	-

The typical I²t is an average value calculated from the breaking capacity tests by using the melting time before the arcing occurs.

Dimensions

Dimensions in mm for reference only.
See outline drawing for dimensions and tolerances.

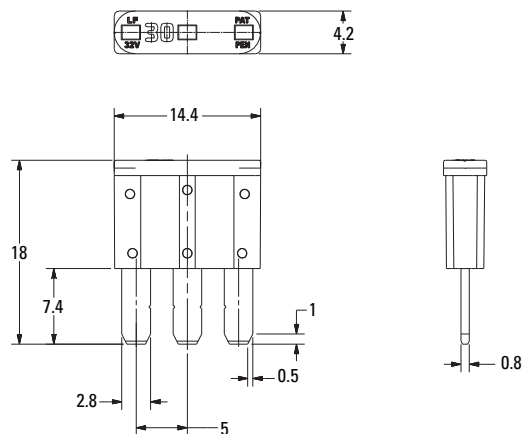

MICRO3™ Blade Fuses

Rated 32V

Time-Current Characteristic Curves

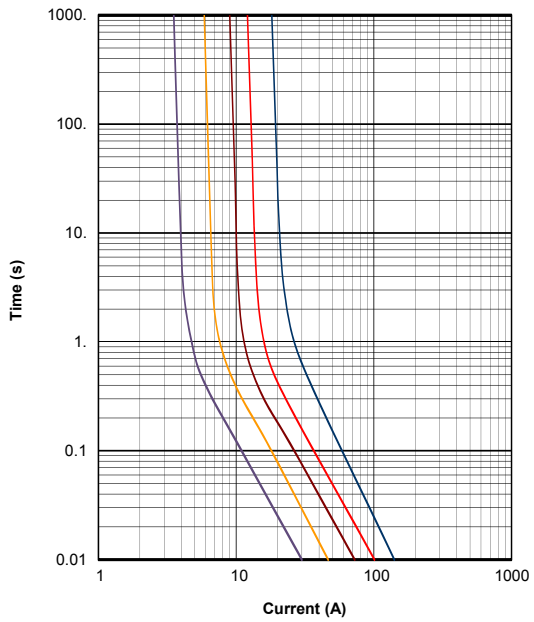

Time-Current Characteristics

% of Rating	Opening Time Min / Max (s)
110	360 000 / ∞
135	0.75 / 120
160	0.3 / 50
200	0.15 / 5
350	0.04 / 0.5
600	0.02 / 0.1

Typical Rerating Curve

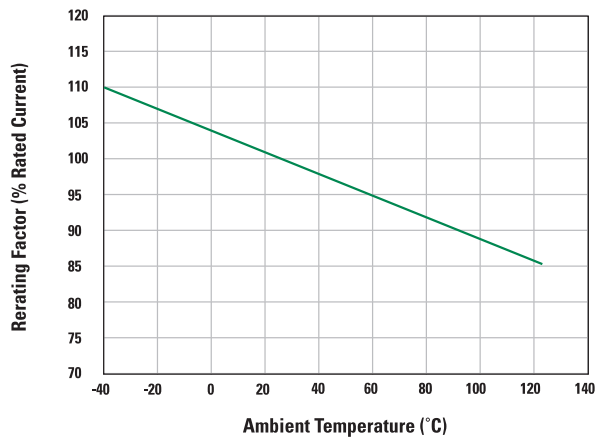

SHUNT Maximum Continuous Load: 15A